

Standard type

RBS RBS-160•250•320







RBS-160

Unit: mm

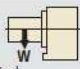
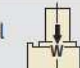
We provide you the top productivity and high-grade machining with no backlash and high indexing speed, two times faster than previous model.

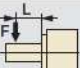
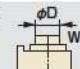
Specifications

		RBS-160	RBS-250	RBS-320
Handedness	R	○	○	○
	L	○	○	○
Spindle diameter		φ100	φ140	φ180
Table diameter*1		φ160 or φ200 (Option)	φ250 (Option)	φ320 (Option)
Center height		160	210	255
Center bore	Nose diameter	φ55H7×45	φ80H7×45	φ115H7×45
	Through-bore	φ40	φ50	φ85
Table T-slot width*1		12H8	12H8	14H8
Guide block width		14h7	18h7	18h7
Servo motors (for FANUC)		αiS4	αiS8	αiS12
Inertia converted into motor shaft ×10 ⁻³ kg·m ²		0.19	0.42	2.24
Net weight kg		60	110	210
Speed reduction ratio		1/36	1/36	1/36
Table max. rpm min ⁻¹ (Motor rpm: 3,000min ⁻¹)		83.3	83.3	83.3
Indexing accuracy (the sum) sec		15	15	15
Clamp system		Pneumatic	Pneumatic	Pneumatic
Clamp torque / pneumatic pressure 0.49MPa N·m		250 (500)*2	600 (1,000)*2	1,000 (1,500)*2
Accessories	Vertical setting  kg	100 (200)	125 (250)	175 (350)
	() : with tailstock			
Options	Horizontal setting  kg	200	250	350
	Technical Information			
Allowable load (when table is clamped)	F  N	10,800	14,400	24,800
	F×L  N·m	250 (500)*2	600 (1,000)*2	1,000 (1,500)*2
	F×L  N·m	780	1,900	4,700
Allowable work inertia $J = \frac{W \cdot D^2}{8}$  kg·m ²	0.64	1.95	4.48	

 Servo motors of other manufacturers **P.66**

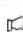
 When assembling a faceplate or a fixture with the main spindle (RNA-B-series) **P.76**

* 1 The tolerance of the table T-slot width is applicable to four standard slots arranged crosswise.  Dimensions **P.60**

* 2 High Clamp Torque model.

Dimensions

Unit:mm

RBS-160

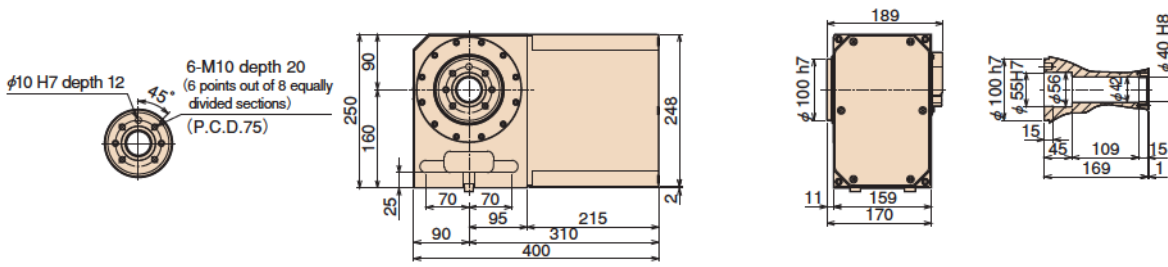

RBS-250

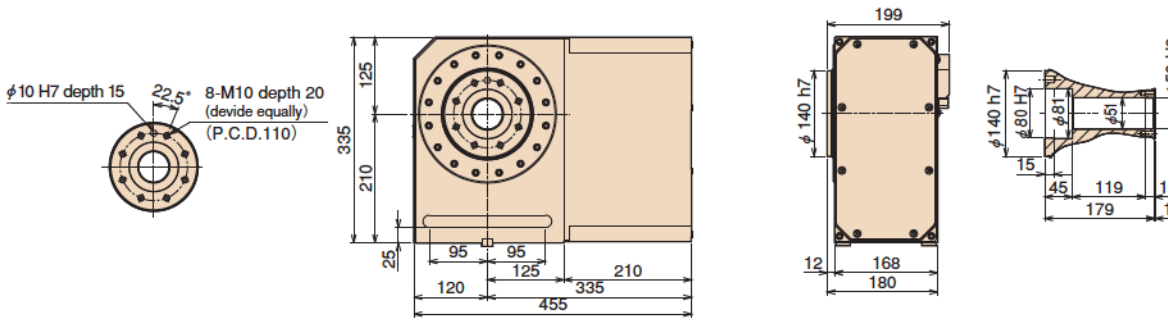

RBS-320

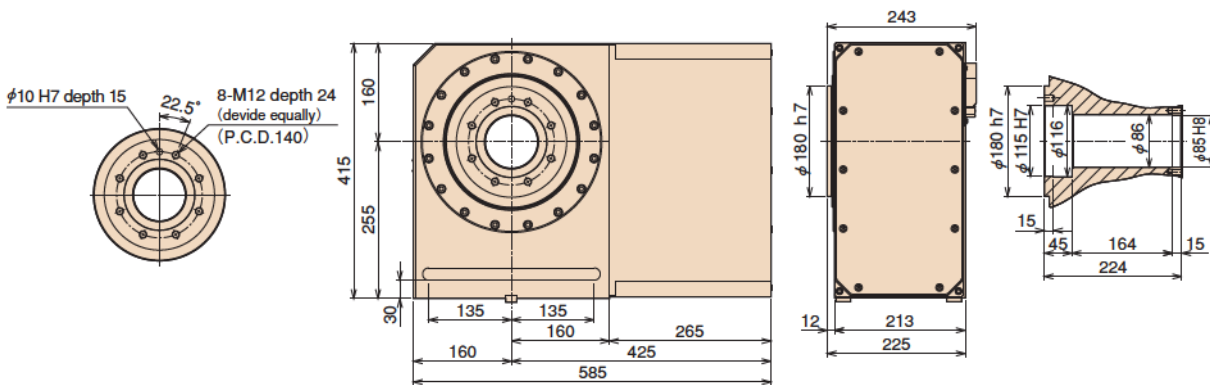

Note: The above dimensions are for FANUC servo motors. The dimensions of servo motors of other manufacturers may be larger.

- RBS**
- TBS
- RWE/RWA
RN
- RWE/RWA-B
RNCV-B
- RNCM
- RWB
- RWB-K
RWCK
- RCH
RNC
- RCV
RNCV
- Multi-Spindle
RWM
- TWA/TN
- TTNC
- THNC
- Multi-Spindle
TWM
- RDS
- RTV
RTT
- RCB
- NC Controllers
- Accessories
- Options
- Technical Information

Clamping block and bolt

Unit: mm

	Q'ty	T-slot pitch	T-slot width	A	B	C	D	E	F	G	H	I	J	K	L	M
RBS-160	2	—	14	—	—	—	—	—	—	—	17	8	60	—	23	12
RBS-250	4	40~120	18	25	12	80	12	33	35	22	21	11	65	40	28	16
RBS-320	4	55~147	18	30	15	90	16	31	43	25	21	11	70	46	28	16

Note 1: When using a machine with a T-slot pitch other than the above, use suitable clamping blocks and bolts that are available on the market, or order custom-made ones from TSUDAKOMA. (Option)

Type I

