

# QLPD-M

# CLAMPING SCREWS (Standard)

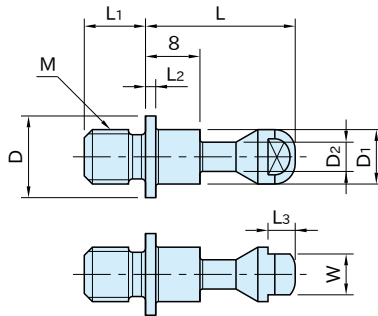

Body
SCM435 steel
Quenched and tempered
Black oxide finish

Part Number	D <sub>1</sub>	M	L <sub>1</sub>	L	D	L <sub>2</sub>	D <sub>2</sub>	W	L <sub>3</sub>	Weight (g)	Pull Clamps
QLPD150-M 5	5	M 5×0.8	6	17	8	1.2	3	4	2.5	3	QLPD150
QLPD150-M 6		M 6×1	7							4	
QLPD200-M 8	8	M 8×1.25	9	22	12	1.5	4.3	6	4	10	QLPD200
QLPD200-M10		M10×1.5	11							13	

## How To Use

### Recommended Spacing Tolerance in Use of Clamping Screws

