

QCPCS-M / QCPCSF-M CLAMPING PINS



Stainless Steel

Heat resistance: 180°C



QCPCS-M



QCPCSF-M

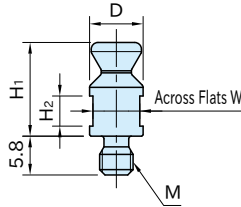
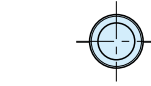

QCPCS-M

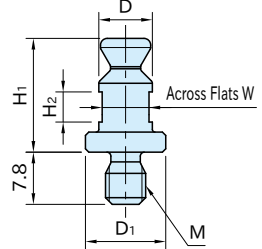
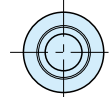

QCPCSF-M

★Key Point
Mounting thread size: M4 to M6

Body
SUS630 stainless steel
Precipitation hardened

QCPCS-M

Part Number	D ($_{-0.05}^{-0.10}$)	M	H ₁	H ₂	W	Weight (g)	Proper Heavy Duty Pin Holding Clamps
QCPCS0625-M4-SUS	6	M4×0.7	13	4	5	3	QCPCS0625-20 QCPCS0625-20-SUS
QCPCS0834-M5-SUS	8	M5×0.8	14	4.5	7	5	QCPCS0834-20 QCPCS0834-20-SUS

Note: Refer to the product pages of clamps for machining accuracy and repeatability.

QCPCSF-M

Part Number	D ($_{-0.05}^{-0.10}$)	D ₁	M	H ₁	H ₂	W	Weight (g)	Proper Heavy Duty Pin Holding Clamps
QCPCSF0625-M5-SUS	6	9	M5×0.8	16	4	5	4	QCPCS0625-20 QCPCS0625-20-SUS
QCPCSF0625-M6-SUS			M6×1				5	
QCPCSF0834-M6-SUS	8	12	M6×1	17	4.5	7	8	QCPCS0834-20 QCPCS0834-20-SUS

Note: Refer to the product pages of clamps for machining accuracy and repeatability.

Note

The color could be different from the picture due to the hardening.

How To Install

QCPCS-M

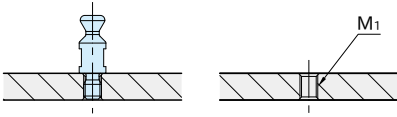

Part Number	M ₁
QCPCS0625-M4-SUS	M4x0.7
QCPCS0834-M5-SUS	M5x0.8

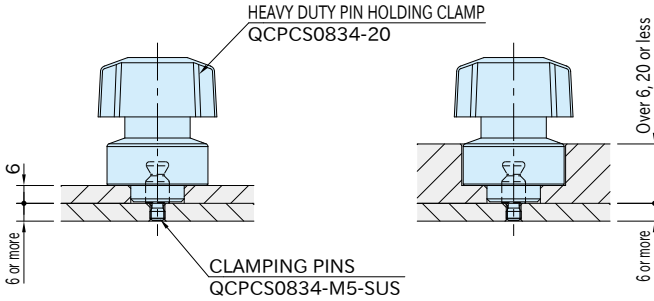

QCPCSF-M

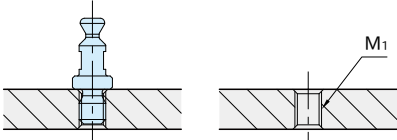

Part Number	M ₁
QCPCSF0625-M5-SUS	M5x0.8
QCPCSF0625-M6-SUS	M6x1
QCPCSF0834-M6-SUS	

