

AMWPD-M

CLAMPING SCREWS

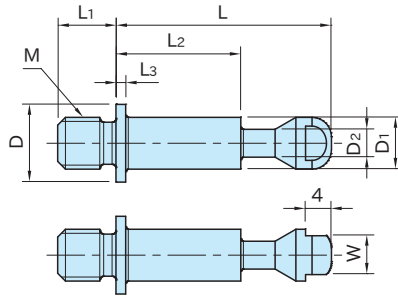

| Body |
|-----------------------|
| SCM435 steel |
| Quenched and tempered |
| Black oxide finish |

| Part Number | D ₁ | M | L ₁ | L | D | L ₂ | L ₃ | D ₂ | W | Proper Pull Clamps | Weight (g) |
|--------------------|----------------|----------|----------------|----|----|----------------|----------------|----------------|----|--------------------|------------|
| AMWPD40-M 8 | 8 | M 8x1.25 | 9 | 38 | 12 | 24 | 1.5 | 4.3 | 6 | AMWPD40-W | 16 |
| AMWPD40-M10 | | M10x1.5 | 11 | | | | | | | | 20 |
| AMWPD63-M12 | 12 | M12x1.75 | 13 | 48 | 20 | 31.5 | 2 | 6.5 | 10 | AMWPD63-W | 50 |
| AMWPD63-M16 | | M16x2 | 17 | | | | | | | | 64 |

How To Use

Recommended Spacing Tolerance in Use of Clamping Screws

±0.2

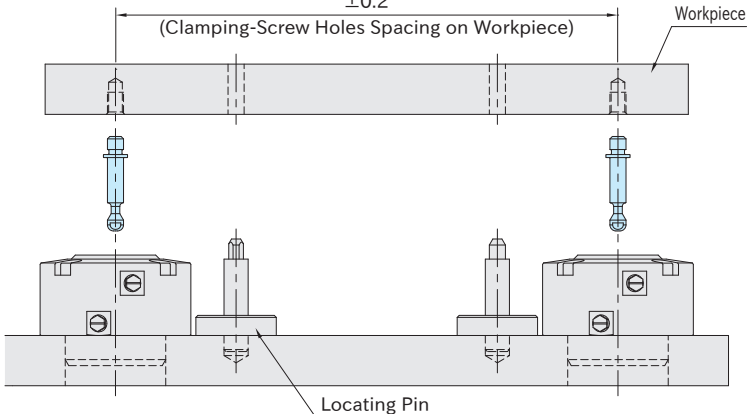

Note

Custom Clamping Screws (different screw thread sizes) are available on request.